

Installation Information

Radio Interface for 15-Pin Accessory Port Connector

Uses Kenwood-provided Molex plug 15-pin (E31-3228-05), comes pre-installed.

Remove 15-Pin Accessory Port Connector.

Remove crimp terminals with jumper from holes 9 and 12

Insert crimp terminals from RCB cable into the correct holes shown below.

If internal speaker is used, insert white external speaker wire with crimp pin into hole 9.

If neither internal or external speakers are used, insulate orange and white wires with heat-shrink tubing.

RCB-xxKI Cable

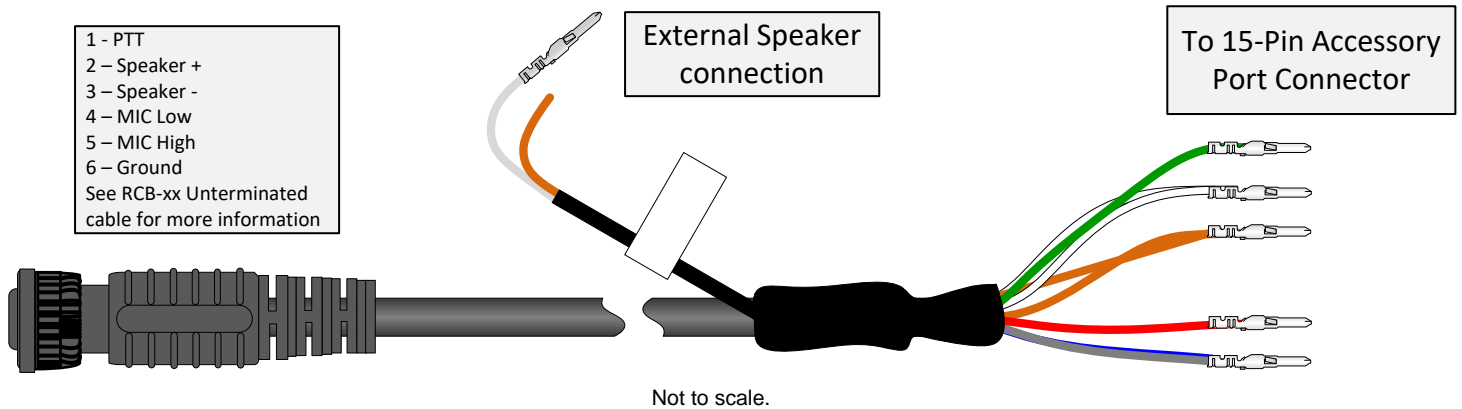

Rear View

TK-6110 radio

NOTE: Requires 15-pin plug from Kenwood (E31-3228-05)

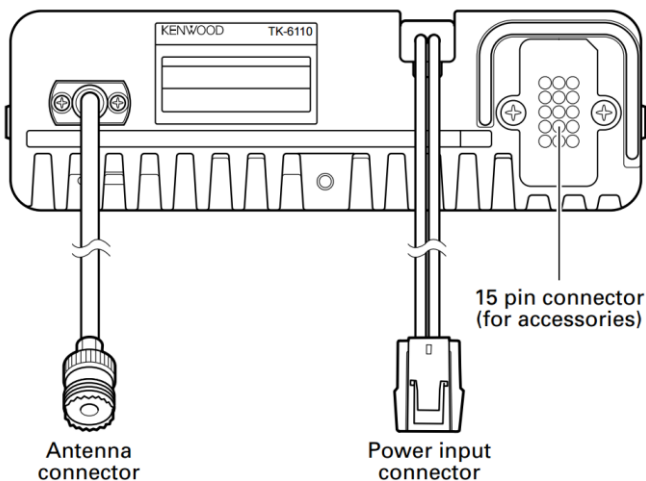

15-Pin Accessory Port Connector

Rear view (E31-3228-05)

Red: Mic Hi
Note: MIC line has a 4.7K Ω Series Resistor

Green: PTT

Leads for External Speaker

Orange: Spkr +

White: Spkr -

Blue/Shield: Ground

